

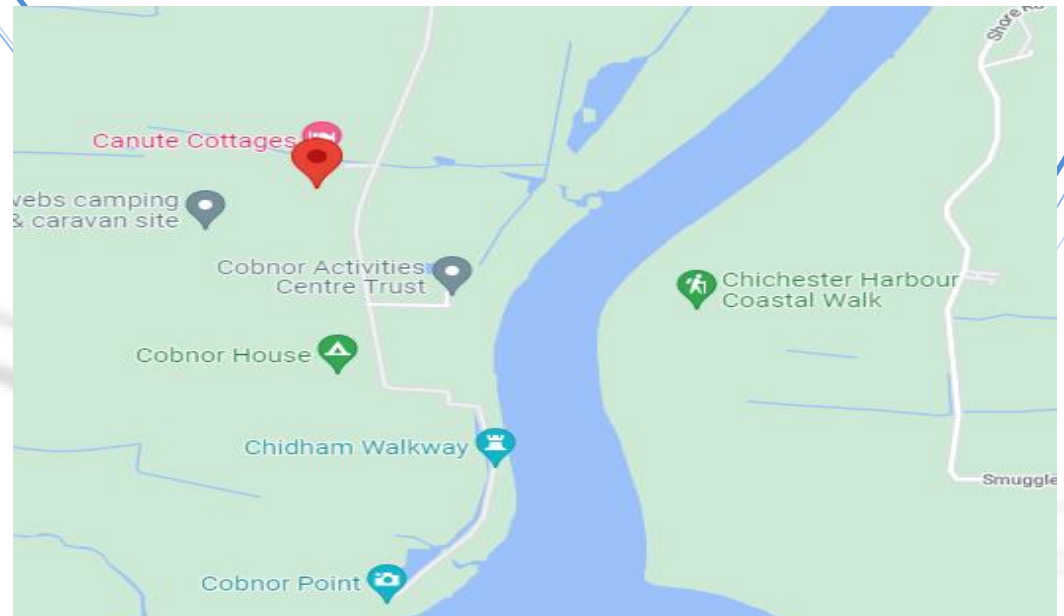

christian youth enterprises

The Location

Jubilee Building,
Chidham,
Chichester,
West Sussex
PO18 8TE

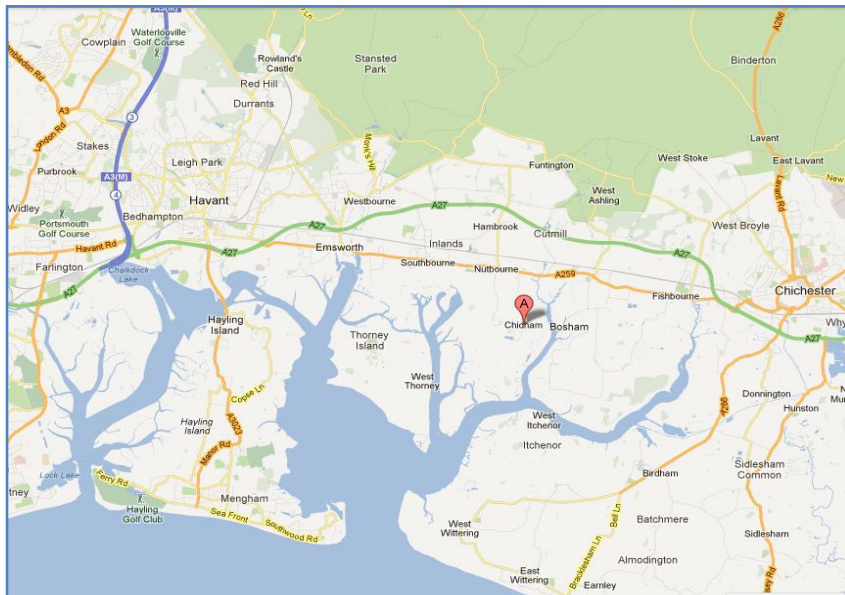

The Ship 'Resolute'



Ship Plan

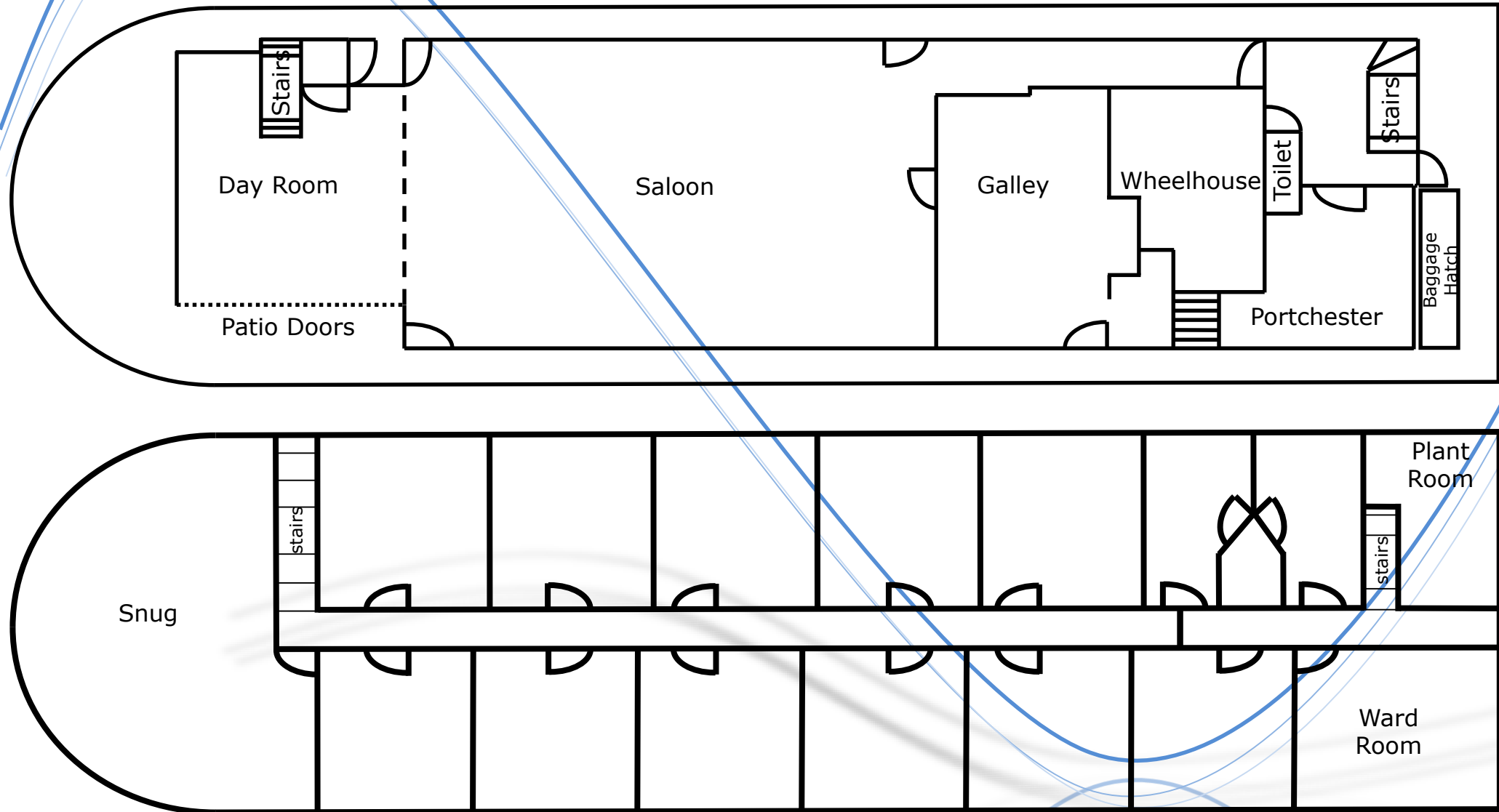

Onshore Facilities



- Drying Room
- Changing Rooms
- Staff Accommodation
- Offices

Timetable

	MORNING	AFTERNOON	EVENING
DAY 1	0920-0940 Staggered Arrival (please organise your parents to drop off at staggered times) 0945 Welcome, briefing 1000 – 1245 1. Rafting 2. Tunnelling 3. LB Sailing	1300 – Packed Lunch 1400 - 1700 1. LB Sailing 2. Rafting 3. Tunnelling	1730 – Dinner 1900 – Campfire 2030 Bed
DAY 2	0800 Breakfast 0915 Assembly 1000 – 1245 1. Tunnelling 2. LB Sailing 3. Rafting	1300 – Lunch 1400- All together team activities 1630 – Staggered Depart	

- The car park is small so if you can share lifts for drop off and pick up that would be really helpful.

CYE's Staff Team

- Dedicated Staff
- Qualified & Experienced
- Developing Skills
- First Aid trained
- All staff CRB checked
- Staff and site exclusively for your group



Safety & Inspection

- BCU and RYA recognised centre
- Safety boat cover on the water
- Regularly inspected by AALA, HSE and the food standards authority



Drascombe Longboats



Tunnelling



Raft Building



Archery



Assault Course



What will I need?



**shoes – long sleeves – warm, old clothes
duvet cover – slippers – packed lunch –
bag for wet clothes – label everything**

Assembly



Any Questions?





Thank you for coming

We look forward to seeing you soon

If you have any further questions please don't hesitate to ask me privately before you leave